

WARNING

INSTALLATION OR MAINTENANCE OF THIS FUEL OIL FILTER MUST BE PERFORMED BY A QUALIFIED SERVICE TECHNICIAN FAMILIAR WITH OIL HEATING SYSTEMS. THE SERVICE TECHNICIAN MUST USE THE PROPER TOOLS AND EQUIPMENT AND BE LICENSED BY THE PROPER AUTHORITY WHERE APPLICABLE. INSTALLATION OR SERVICE WORK PERFORMED BY AN UNQUALIFIED PERSON COULD RESULT IN HAZARDS TO THAT PERSON, OTHER PEOPLE AND THE ENVIRONMENT. THESE HAZARDS COULD INCLUDE, BUT ARE NOT LIMITED TO, FUEL OIL SPILLS, FIRE, SEVERE BURNS, DAMAGE TO HEATING SYSTEM COMPONENTS AND OTHER HAZARDS. IF BIO-DIESEL FUELS OUTSIDE ASTM STANDARD D396-09 ARE USED, INSTALL GREEN BIOGASKET™ BG-1A.

INSTALLATION AND MAINTENANCE

This filter is for use with stationary Fuel Oil appliances only. The filter must be installed in the suction line between the storage tank and burner where it will protect the fuel pump and burner nozzle from impurities. It may be installed either at the tank or at the burner. On underground storage tanks, the filter may be installed in the suction line where it enters the building. The filter must be installed so that NONE of the components in the assembly are in contact with the ground, any source of constant moisture or any source of electric current as these will shorten the life of the filter.

On a one pipe system, the oil flow is equal to the nozzle capacity. On two pipe systems (suction and return), the oil flow through the filter is full pump capacity. It may be necessary to replace the cartridge more often because of the higher flow rate.

INSTALLATION

1. Turn off electricity to burner and close shut-off valve in fuel line.
2. Install filter between shut-off valve and burner with filter bowl down. Oil flow through filter must be as indicated by words "IN" and "OUT" on filter head.
3. Install 3/8" steel pipe (not included) or brass fittings (not included) as required to make transition to fuel line. Use an oil resistant pipe joint compound on all pipe threads. Tighten all fittings using two wrenches.
4. Open fuel shut-off valve. Place a container under filter and remove vent screw until oil shows at the vent port. Tighten vent screw and check all connections for leaks.
5. Prime fuel pump, if necessary, and run burner for approximately 10 minutes. Re-check all connections for leakage.
6. Technician **MUST ENSURE** there are no leaks from any part of the filter assembly prior to completing the installation. If there are any leaks, it is the responsibility of the technician to either repair the leak or replace the filter with a new unit.

INSPECTING THE FILTER AND CHANGING THE CARTRIDGE

The oil filter must be inspected and the cartridge replaced each heating season. To begin the inspection, follow the instructions below:

1. Turn off electricity to burner and close shut-off valve in fuel line.
2. Loosen center bolt and remove filter bowl.
3. Discard used filter cartridge in plastic disposal bag provided, clean filter bowl and **INSPECT FOR DAMAGE**. If any of the following are seen during the inspection, the damaged parts or entire oil filter assembly must be replaced:
 - A. Surface flaws or corrosion inside or outside the filter bowl, including but not limited to:
 - Scratches or flaking of the filter bowl coating.
 - Areas of missing coating with bare metal exposed.
 - Visible red or white rust in any area of the filter bowl.
 - Surface imperfections including pitting or bubbling.
 - B. Potential leaks or signs of leaks coming from any area of the filter.
 - C. Any signs the lower bolt has been tampered with. (Do NOT attempt to loosen this bolt)
 - D. Surface flaws or visual defects inside or outside the cast iron head, including but not limited to:
 - Visible red rust in any area of the head.
 - Areas of missing coating on the outside with the bare casting exposed.
 - Surface imperfections including pitting or cracking.
 - E. Surface flaws or corrosion on the center bolt, vent screw or any internal components including hex coupler and sealing cup.

WARNING: Failure to perform a thorough inspection could result in a leaking oil filter and potential lawsuits. Only if the oil filter passes the visual inspection above, may the installer proceed with replacing the filter cartridge by following the instructions below:

4. Install the new cartridge and gaskets for the bowl, center bolt and vent screw provided. Use of Bio-Diesel Fuel with any Buna-N rubber gaskets can result in gasket damage and leakage. If Bio-Diesel Fuels are used, install the green BioGasket™ BG-1A.
5. Reassemble bowl to filter head and tighten center bolt.
6. Open fuel valve and vent filter as described in Step 4 under installation.
7. Run burner and check filter for leakage.
8. Technician **MUST ENSURE** there are no leaks from any part of the filter assembly prior to completing the installation. If there are any leaks, it's the responsibility of the technician to either repair the leak or replace the filter with a new unit.

1A-25B FUEL OIL FILTER

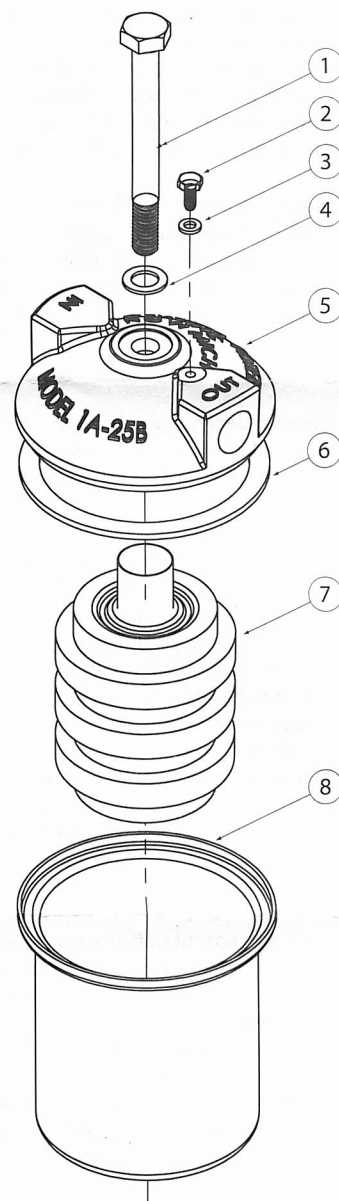

PARTS LIST

ITEM	NUMBER	NAME
1	1A-33	CENTER BOLT
2	1A-38	VENT SCREW
3	1A-39	VENT GASKET
4	1A-58	CENTER GASKET
5	1A-26A	FILTER CAP
6	BG-1A	BOWL GASKET
7	1A-30BG	CARTRIDGE
8	1A-29	BOWL ASSY.

GENERAL FILTERS, INC.
43800 GRAND RIVER AVE.
NOVI, MI 48375 USA
TEL 248-476-5100

CANADIAN GENERAL FILTERS, LTD
400 MIDWEST ROAD
TORONTO, ON CANADA M1P3A9
TEL 416-757-3691