



# 664 PRESSURE REGULATOR VALVE

The EBW 664 pressure regulator valve is designed to be used in conjunction with suction type dispensers connected to an aboveground storage tank. The pressure regulator valve prevents fuel from flowing to the pumping unit and flowing out the vent tube of the self-contained dispenser when the pump is not activated. The pressure regulator valve is a vacuum actuated valve which will not allow product flow until the suction of the pumping unit opens the valve. The valve closes by means of an internal spring when pumping is complete.

## HIGHLIGHTS

- Hydrostatic pressure adjusting mechanism with durable weather cap.
- Built in thermal expansion pressure relief valve.
- Shear section is standard, eliminating need for an additional shear valve.
- NFPA 30.
- API/RP 2000.

## MATERIALS

- Body: cast iron.
- Seals: fluorocarbon.
- Filter: stainless steel.
- Poppet: fluorocarbon.

Model	Description	Weight	
		Lbs	Kg
66430201	Male-NPT	19.00	8.62
66430202	Union	19.30	8.75
66430203	Female-NPT	19.00	8.62
66430206	Female-Poppeted	19.00	8.62
66430226	Female-BSPT	19.00	8.62
Model	Description		
66222001	Male replacement adapter		
66421101	Female replacement adapter for 664-302-06		
66430401	Mounting bracket		

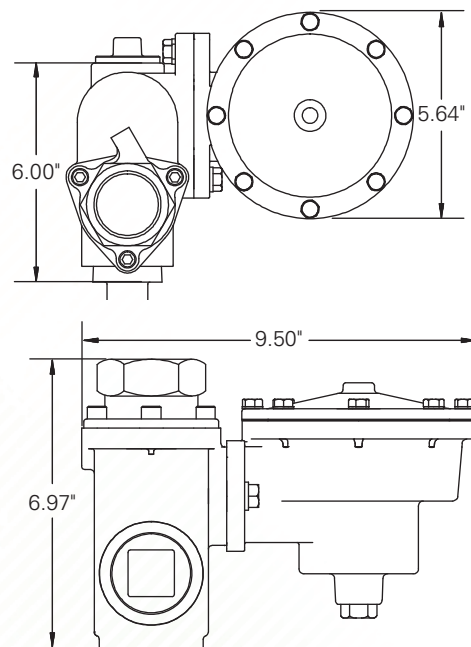
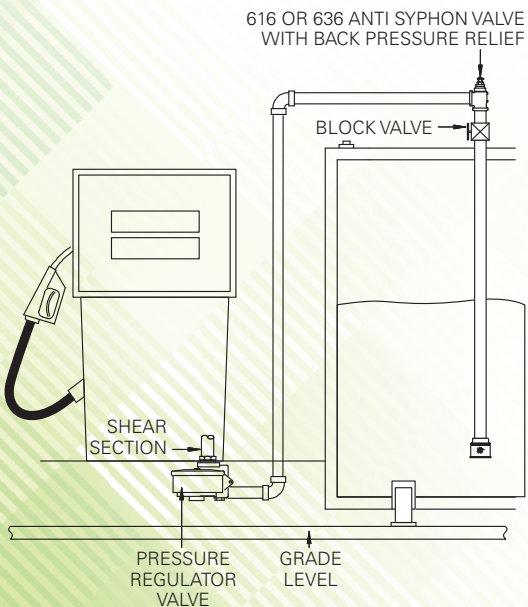

Note: Please refer to the installation instructions supplied with the valve for proper installation procedures.